

WEEBLug UNIRAC PN 008002S
Conductor: See product data sheet

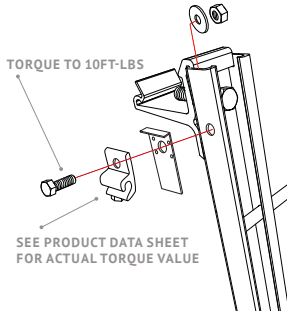

IlSCO lay-in Lug IlSCO PN GBL-4DBT
Conductor: See product data sheet

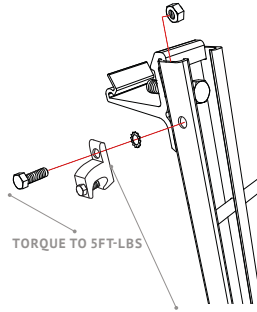

Grounding Lug Mounting Details:

Details are provided for both the WEEB and IlSCO

products. The WEEBLug has a grounding symbol located on the lug assembly. The IlSCO lug has a green colored set screw for grounding indication purposes. One lug is recommended per string. Installation must be in accordance with NFPA NEC 70, however the electrical designer of record should refer to the latest revision of NEC for actual grounding conductor cable size.

Ground Lug	Bolt size	Drill size
WEEBLug	1/4"-20	17/64"
IlSCO	#10-32	7/32"

TORQUE VALUE DEPENDS ON CONDUCTOR SIZE.
SEE PRODUCT DATA SHEET FOR TORQUE VALUE.

OPTIONAL MICRO-INVERTER MOUNTING

OPTIONAL ROOF PAD

Note:
Mounting & electrical bonding of micro inverter must be in accordance with MFR's recommendations

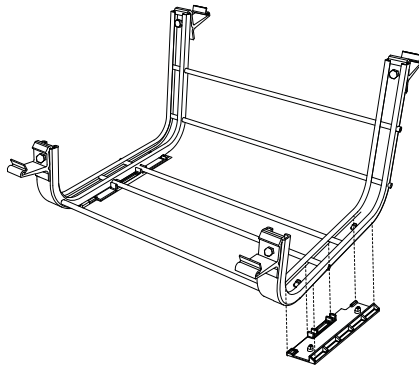
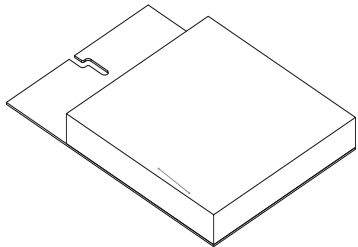

PUB140221



RM ROOF MOUNT

Quick Start Guide

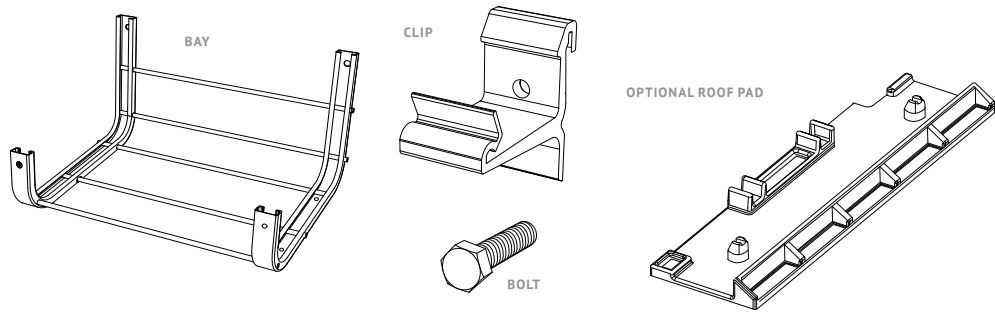

ATTACH CLIPS LOOSELY TO BAY POSTS INTENDED TO HOLD MODULES

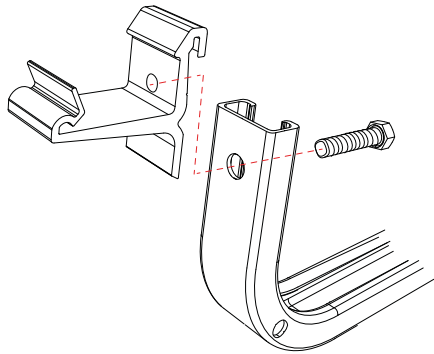

NOTE:
For complete electrical bonding path, clips must be tapped in place with hammer.

LOCATE ARRAY ON ROOF

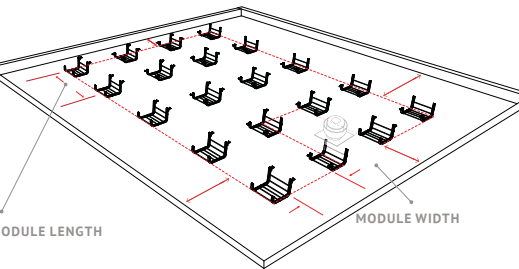

MARK ROOF WHERE ARRAY WILL START

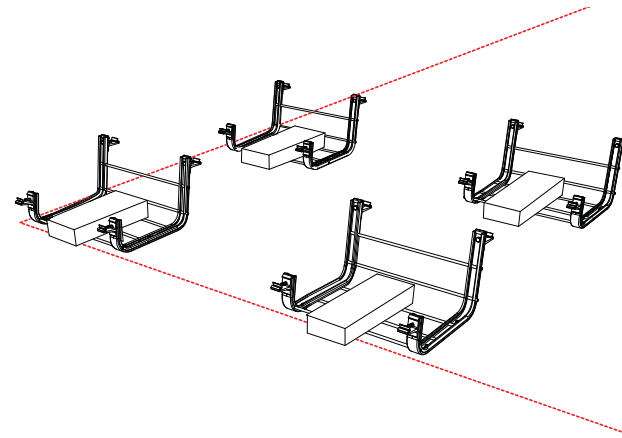
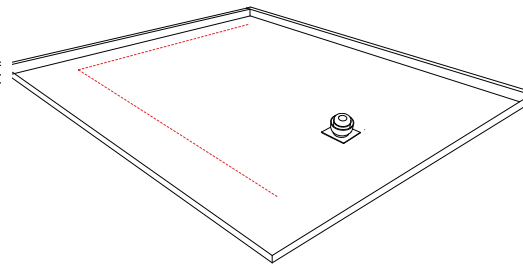

PLACE MODULE IN CLIPS AND TIGHTEN BOLTS

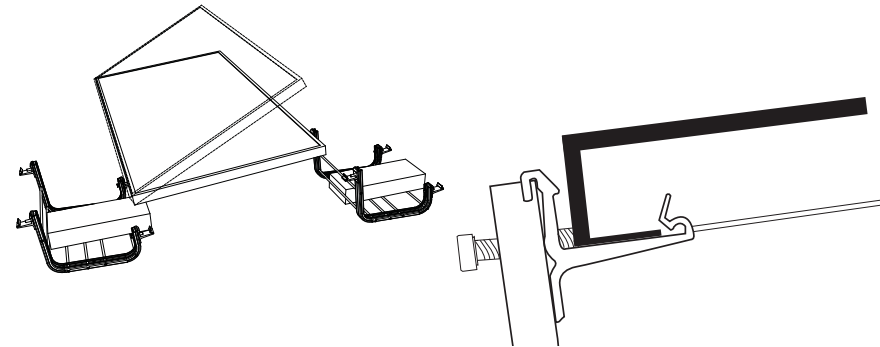

PLACE ANOTHER MODULE IN NEXT BAY CLIPS

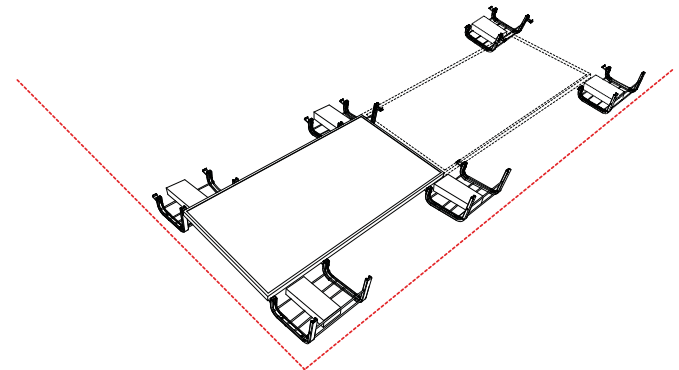

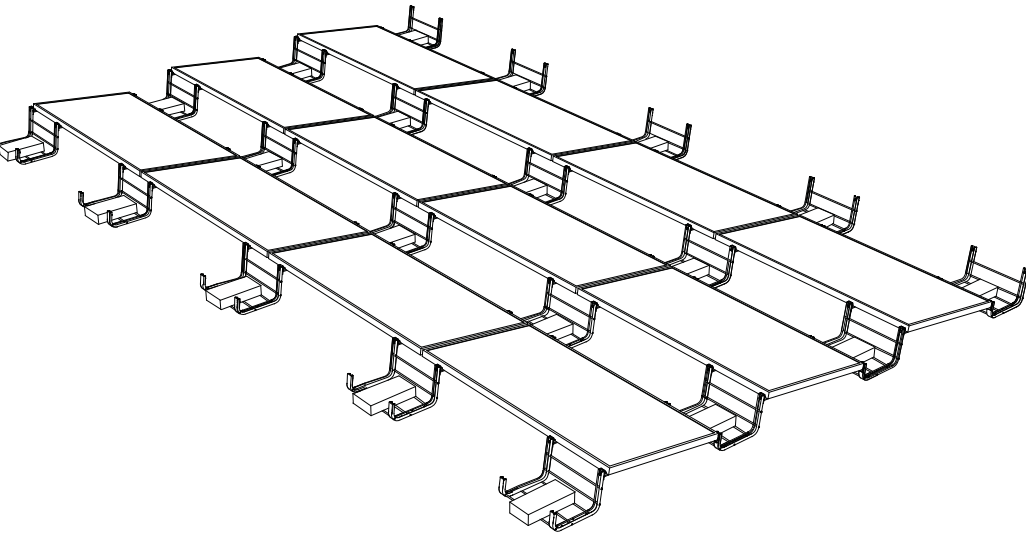

TORQUE CLIP BOLTS IN SEQUENCE

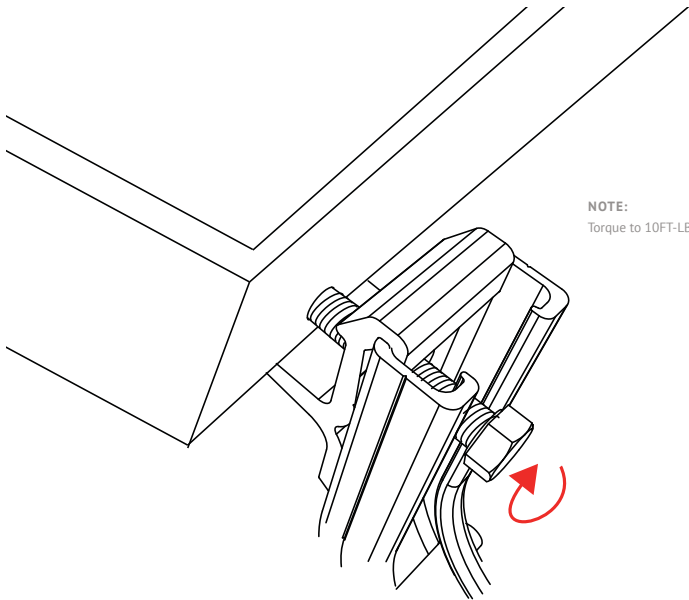

NOTE:
Torque to 10FT-LBS

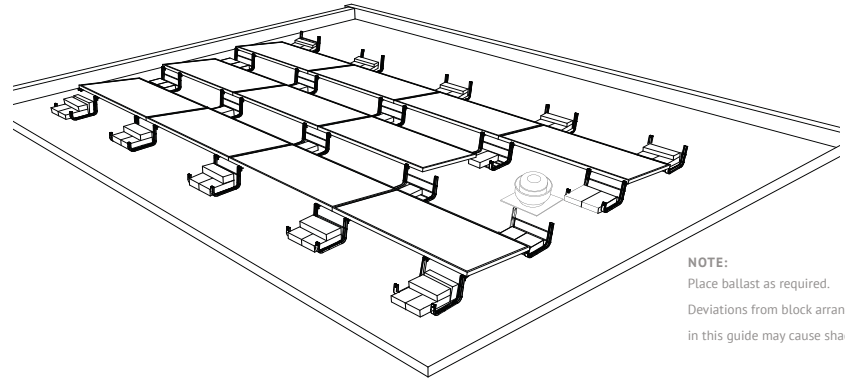

NOTE:
Place ballast as required.
Deviations from block arrangements shown
in this guide may cause shading

OPTIONAL WIRE MANAGEMENT

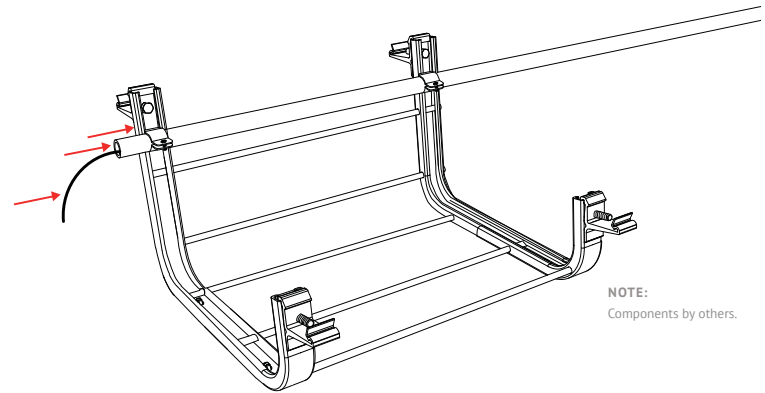

NOTE:
Components by others.

CONNECT GROUNDING LUG
AS REQUIRED BY CODE AND ENGINEER OF RECORD

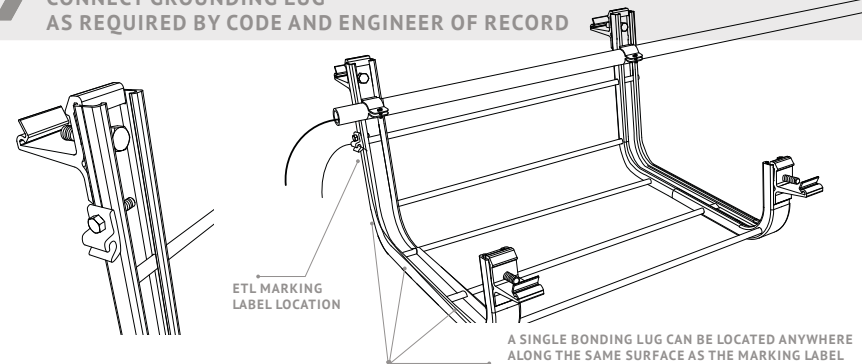

ETL MARKING
LABEL LOCATION

A SINGLE BONDING LUG CAN BE LOCATED ANYWHERE
ALONG THE SAME SURFACE AS THE MARKING LABEL